



WKD 380 Submittal



NAD Klima Ontario
2840, Argentia Road, Unit 6, Mississauga (Ont) L5N 8G4
(416) 860-1067
ontario@nadklima.com

NAD Klima
144 rue Léger, Sherbrooke (Qué) J1L 1L9
(819) 780-0111 • 1 866 531-1739
info@nadklima.com

Date

Project

Engineer

Contractor

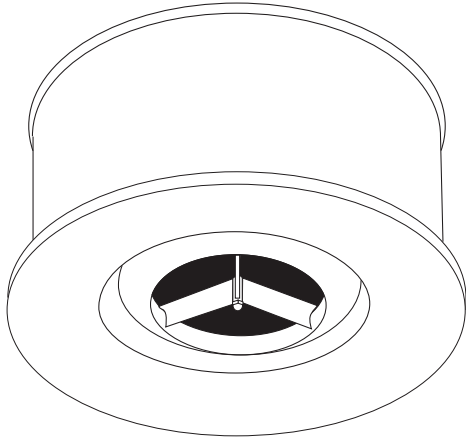

The diffuseur

- Air swirl diffuser.
- Square or round diffuser.
- Made of steel.
- Equipped with a turbulence chamber composed of a round plate with stamped blades.
- Manual or motorized mode adjustment mechanism.
- Powder coated with a polyester TGIC-free paint.
- RAL colour chosen by client.

Configuration

The WKD 380 diffuser is composed of a cylindrical swirl chamber (1), around which are placed blades to direct air (2) to the deflector (3), and an long-range nozzle adjustable manually or motorized (4). These components are located in a plenum (5).

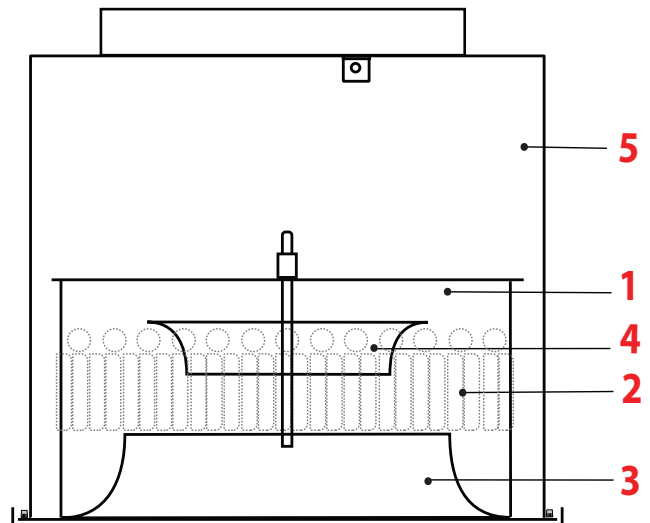

WKD - 380 - Flow and direction of air

Mode of operation

The air flow entering the turbulence chamber (1) creates an intensive helical movement, depending on the positioning of the nozzle (4). The airflow at the deflector outlet (3) will produce air induction and a variable penetration.

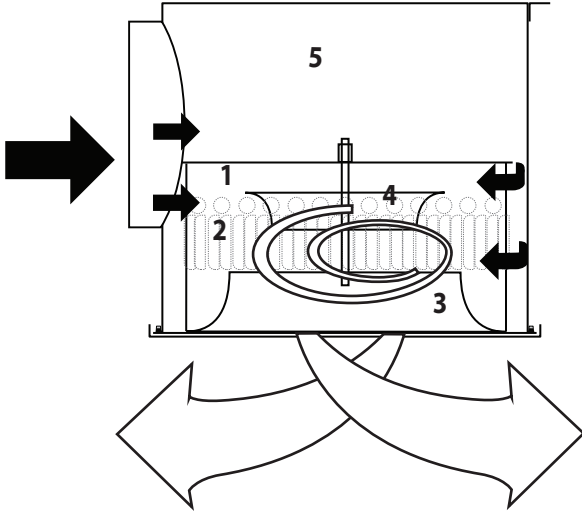

Operation



Heating

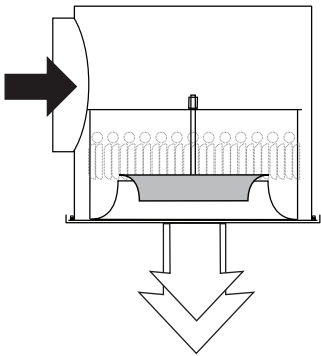

Nozzle Position 1
Stable vertical air flow
with large penetration



Cooling

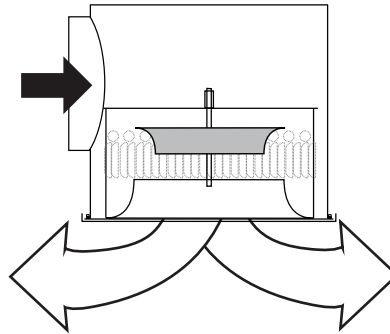

Nozzle Position 3
Horizontal helical air flow
and a relatively weak reach

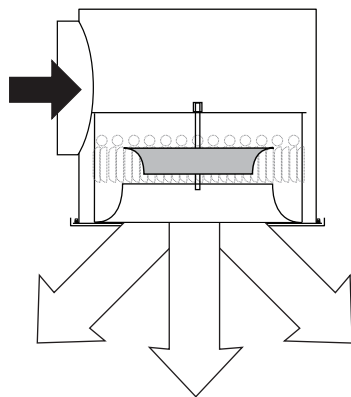

Nozzle Position 2
Vertical airflow with
a helical effect

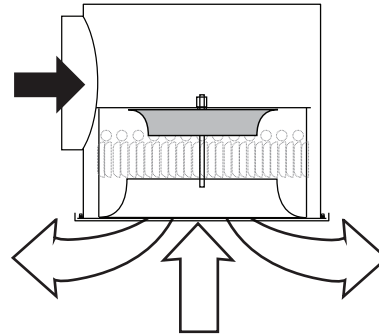

Nozzle Position 4
Horizontal air flow
(even in free suspension)
with a maximal
horizontal reach and an
elevated primary induction

WKD - 380 - Dimensions

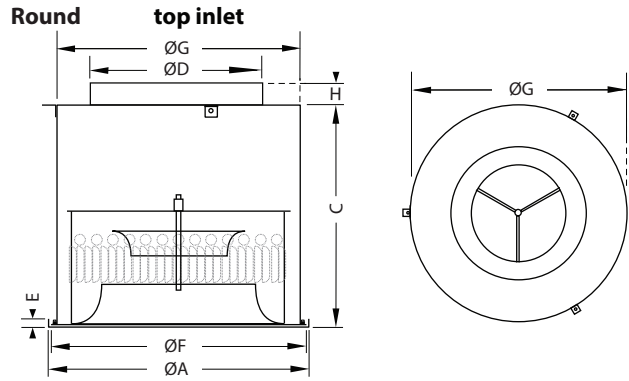
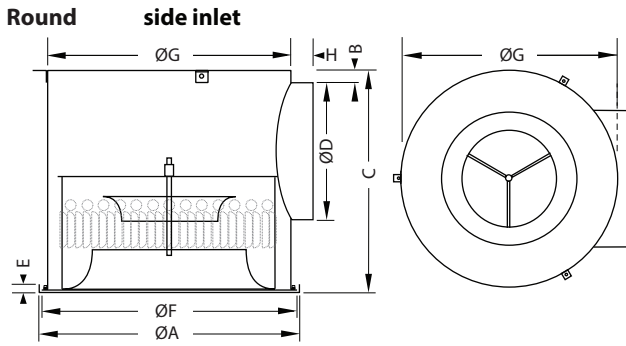

	DN 600 (mm)	DN 800 (mm)	DN 1000 (mm)
Size ØA	600	800	1080
Size B	33	33	33
Size C	504	701	800
Size ØD	350	498	598
Size E	7	7	7
Size ØF	580	790	1060
Size ØG	560	770	1040
Size H	50	50	50
Weight (kg)	27,5	53	66,3

	DN 600 (mm)	DN 800 (mm)	DN 1000 (mm)
Size ØA	600	800	1080
Size C	504	701	800
Size ØD	400	498	598
Size E	7	7	7
Size ØF	580	790	1060
Size ØG	560	770	1040
Size H	50	50	50
Weight (kg)	27,5	53	66,3

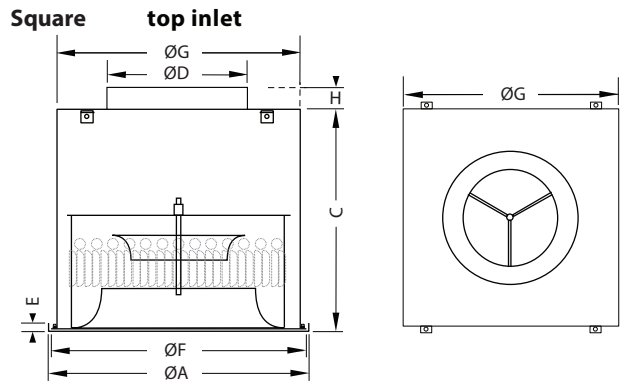
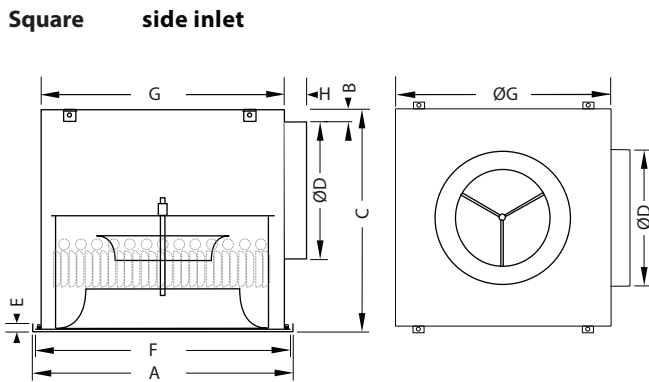

	DN 600 (mm)
Size A	603
Size B	33
Size C	504
Size ØD	350
Size E	12
Size F	580
Size G	560
Size H	50
Weight (kg)	27,5

	DN 600 (mm)
Size A	603
Size C	504
Size ØD	350
Size E	12
Size F	580
Size G	560
Size H	50
Weight (kg)	27,5

WKD - 380 - Codification

WKD 380					Product
Q = Square (only DN 600) R = Round					Configuration
0600, 0800, 1000					Nominal dimension
9003 = White 9010 = Cream 00SB = Solar Black (Standard matte black) 00SM = Silver Matte (Standard metallic grey) _____ = RAL color (write the RAL color number)					Diffuser color
T = Plenum with inlet on the top S = Plenum with inlet on the side					Plenum
H = Hand adjustment M = Motorized adjustment					Adjustment
WKD 380	Q	0600	9003	T H	Example